

Big Blue® 450 Duo CST™

**Diesel Engine-Driven
Welder**



Quick Specs

Heavy Industrial Applications

Pipe welding
Structural
General fabrication
Maintenance and repair
Rental fleets

Processes

Stick (SMAW)
DC TIG (GTAW) Lift-Arc™
Air carbon arc (CAC-A)
Rated: 3/16-inch (4.8 mm)
carbons (paralleled)
Air plasma cutting and gouging
with optional Spectrum® models

Output Range

DC stick/TIG 5–280 A (separate), 10–450 A (paralleled)

Auxiliary Output Rated at 104°F (40°C)

12,000 watts peak, 10,000 watts continuous

Durable dual-operator engine-driven welder.

The Big Blue 450 Duo CST delivers proven CST stick/TIG performance with two superior arcs in one compact package, for maximum productivity and efficiency.



Mitsubishi S4L2 four-cylinder diesel. Used in industrial applications around the world, the S4L2 is designed to run 10,000 hours before major overhaul.

Superior stick arc performance even on the difficult-to-run electrodes like E6010.

Adaptive Hot Start™ for stick arc starts automatically increases the output amperage at the start of a weld should the start require it. Prevents the electrode from sticking and creating an inclusion.

Lift-Arc™ start for TIG starts without the use of high frequency.

Remote amperage control provided through 14-pin receptacle on front of the machine permits the use of standard and wireless amperage control devices.

Vandalism lockout kit (not shown). Lockable hinged steel panel protects front control panel and ignition switch.



Meter maintenance displays.

- Hour meter function
- Oil change interval
- High coolant temperature and low oil pressure shutdowns
- Low fuel shutdown—engine shuts down before system runs out of fuel, making restarts easy

Quiet operation. At just 71 decibels at 23 feet (7 m), it's quieter than most single-operator models, improving jobsite communication and safety.

Thermal overload protection prevents machine damage if the duty cycle is exceeded or airflow is blocked.

High efficiency. Three-phase, rotating-field auxiliary requires less fuel and horsepower to operate.

See page 3 for more machine features/benefits.



Engine-driven welder is warranted for three years, parts and labor.
Engine is warranted separately by the engine manufacturer.



Miller Electric Mfg. LLC
An ITW Welding Company
1635 West Spencer Street
P.O. Box 1079
Appleton, WI 54912-1079 USA

Equipment Sales US and Canada
Phone: 866-931-9730
FAX: 800-637-2315
International Phone: 920-735-4554
International FAX: 920-735-4125

MillerWelds.com
f t y i n



Specifications (Subject to change without notice.)



Weld Mode/Process	Output Mode	Weld Output Range	Weld Output Rated at 122°F (50°C)	Max. Open-Circuit Voltage	Auxiliary Power Output Rated at 122°F (50°C)	Sound Levels at Rated Output, 23 ft. (7 m)	Dimensions	Net Weight (without fuel)*
CC/DC (Stick/TIG)	Separate (dual outputs)	5–225 A (each side) 5–280 A (one side only)	175 A at 27 V, 100% duty cycle	77	12,000 watts peak, 10,000 watts continuous 1-phase, 120/240 VAC, 60 Hz	71 dB (96 Lwa)	H: 32 in. (813 mm) W: 26.25 in. (667 mm) D: 56 in. (1,422 mm)	1,064 lb. (483 kg)
	Paralleled (combined)	10–450 A	350 A at 27 V, 100% duty cycle					

*Additional 82 lb. (37 kg) when fuel tank is full.

Certified by Canadian Standards Association to both the Canadian and U.S. Standards. Meets NEMA and IEC output ratings.

Engine Specifications (Engines warranted separately by the engine manufacturer.)

Engine Brand	Features	HP	Type	Engine Speeds	Capacities	Automatic Engine Shutdown
Mitsubishi S4L2	EPA Tier 4 Final compliant	24.7	Four-cylinder, liquid-cooled industrial diesel	Weld: 1,800 rpm	Fuel: 11.5 gal. (43.5 L) Oil: 5.8 qt. (5.5 L) Coolant: 10 qt. (9.5 L)	Low oil pressure, high coolant temperature, low fuel level

Performance Data

Fuel Consumption Curve

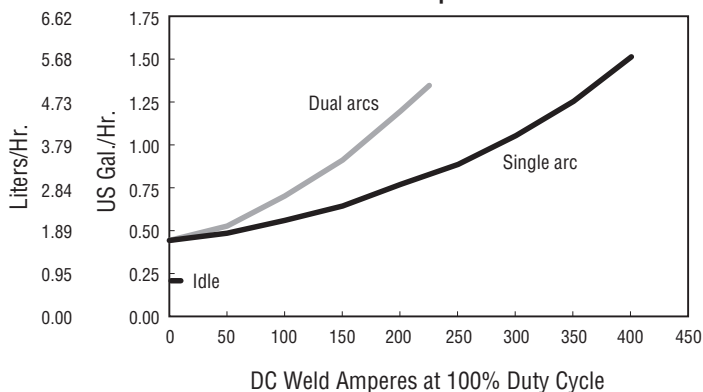

Simultaneous Welding and Power

Weld Amperes	Total 1-Phase Aux. Power Available (Watts)
No Weld Output	10,000
200 A	5,200
300 A	2,700
400 A	0

Function Guide

- Output light
- On/off switch
- Weld process selector switch
- Overtemp light
- Amperage adjustment control (5–280 amps)
- Standard 14-pin receptacle for simple connection of remote controls and wire feeders. Includes **Auto Remote Sense™** which automatically switches from panel to remote amperage/voltage (A/V) control with remote connected. Eliminates confusion of a panel/remote switch.
- Negative (–) weld output terminal
- Glow plugs assist in cold weather starting.
- Meter maintenance displays show fuel level, engine hours, oil change interval and high temp/low pressure/low fuel shutdown information.
- Engine control switch is used to start and stop the engine and select power range.
- 50 A, 120/240 V receptacle
Note: For matching plug, order 119172.
- 120 and 240 V circuit breakers
- 20 A, 120 V GFCI receptacles

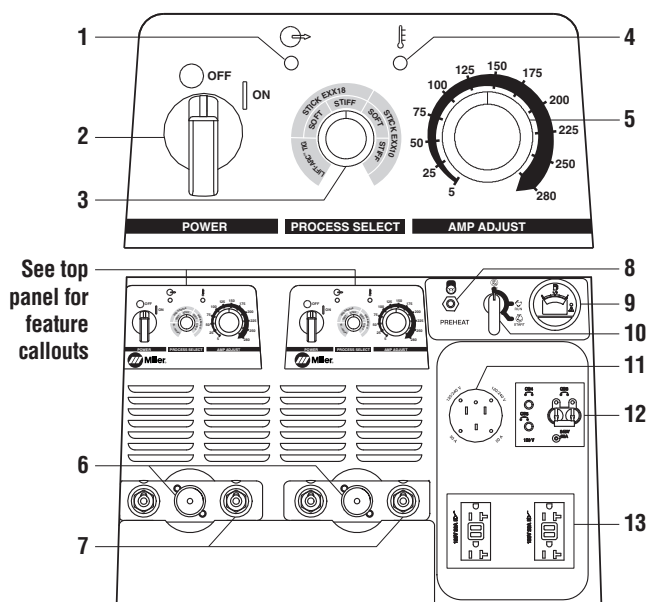

Genuine Miller® Accessories



Full KVA Plug Kit 119172 Field
1-phase, 120/240 V, 50 A plug (NEMA 14-50P) to fit full KVA receptacle.



Female Receptacle

Full KVA Adapter Cord 300517 Field
NEMA 14-50P to NEMA 6-50R. Adapts engine drive 120/240 V plug to common Millermatic® and Spectrum® 240 V plug.

Engine Filter Kit 252782 Field
Includes all filters required for proper engine maintenance. Oil filter, primary and secondary fuel filter, and primary air filter.



Spark Arrestor (Muffler) Kit 300585 Field
Prevents particles from leaving the muffler that could potentially start a fire. Mandatory when

operating on California grasslands, brush, or forest-covered land, and in all national forests. For other areas, check your state and local laws. Meets U.S. Forest Service Standard 5100-1B.



FA-1D Lockable Flame Arrestor Fuel Cap 043947 Field
Fuel cap can be padlocked to prevent vandalism. A built-in flame arrestor prevents flames or sparks from entering the fuel tank.



Protective Cover 195301 Field
Blue water-resistant cover with Miller logo resists stains and mildew, and protects the finish of your welder.

Stick (SMAW) Welding

Weld Leads

No. 2 Stick Cable Set, 15 ft. (4.6 m) 195196
Consists of 15-foot (4.6 m) No. 2 electrode cable with holder, and 15-foot (4.6 m) work cable with clamp. 200 A, 100% duty cycle.

No. 2 Stick Cable Set, 50 ft. (15 m) 300836
Consists of 50-foot (15 m) No. 2 electrode cable with holder, and 50-foot (15 m) work cable with clamp. 200 A, 100% duty cycle.

2/0 Stick Cable Set, 50 ft. (15 m) 173851
Consists of 50-foot (15 m) 2/0 electrode cable with holder, and 50-foot (15 m) work cable with clamp. 350 A, 100% duty cycle.

2/0 Stick Cable Set, 100/50 ft. (30.5/15 m) 043952
Consists of 100-foot (30.5 m) 2/0 electrode cable with holder, and 50-foot (15 m) work cable with clamp. 300 A, 100% duty cycle.

TIG (GTAW) Torches



Weldcraft® TIG Torches WP-17V-12-2
150 A, 12 ft. (3.7 m)
Air-cooled torch with valve, two-piece cable.

WP-17V-25-2 150 A, 25 ft. (7.6 m)
Air-cooled torch with valve, two-piece cable.

WP-26V-25-2 200 A, 25 ft. (7.6 m)
Air-cooled torch with valve.

Two-cable TIG torches require the installation of Tweco-style connector 191981.

Plasma Cutting



Spectrum® 375 X-TREME™ 907529
See literature PC/9.2.

Spectrum® 625 X-TREME™ 907579 with 12-foot (3.7 m) torch
907579001 with 20-foot (6.1 m) torch
See literature PC/9.6.

The Spectrum 375 X-TREME and 625 X-TREME come complete with protective X-CASE™ (not shown).

Remote Controls



Wireless Remote Hand Control* 301582
For remote current, voltage and contactor control. Receiver plugs directly into the 14-pin receptacle of Miller machine. Up to 300-foot (91.4 m) operating range.

Wireless antenna kit **300749** is recommended.



Wireless Remote Foot Control* 301580
For remote current control. Receiver plugs directly into the 14-pin receptacle of Miller

machine. 90-foot (27.4 m) operating range. Wireless antenna kit **300749** is recommended.



PRHC-14 Hand Control* 195511

Complete current control brings 120 volts of GFCI power to work area in a single cord. Housed in a durable and light aluminum case and includes 125-foot (38 m) cord with plugs.



RHC-14 Hand Control* 242211020

Miniature hand current control. Dimensions: 4 x 4 x 3.25 inches (102 x 102 x 82 mm). Includes 20-foot (6 m) cord and 14-pin plug.



RCC-14 Remote Current Control* 151086

East/west rotary-motion fingertip control attaches to TIG torch using two hook-and-loop fasteners. Includes 26.5-foot (8 m) cord and 14-pin plug.



RCCS-14 Remote Current Control* 043688

North/south rotary-motion fingertip control attaches to TIG torch using two hook-and-loop fasteners. Includes 26.5-foot (8 m) cord and 14-pin plug.



RFCS-14 HD Foot Control* 194744

Heavy-duty foot current control. Includes 20-foot (6 m) cord and 14-pin plug.

Extension Cables for 14-Pin Remote Controls

242208025 25 ft. (7.6 m)
242208050 50 ft. (15.2 m)
242208080 80 ft. (24.4 m)

**Controls only amperage on the Big Blue 450 Duo CST—electrode always hot.*

Cable Connectors and Adapters



Tweco®-Style Connector 191981
Accepts #1/0 to #2/0

AWG cable. Kit includes one male Tweco-style plug which attaches to the work and/or weld cables and plugs into the Tweco-style receptacles on the power source.



Tweco®/Dinse Adapter 210061

One-piece adapter with a male Tweco-style plug (to power source) on one end and a female Dinse-style receptacle (for weld cable connection) on other end.

Dinse-Style Connector Kit 042418

Accepts #4 to #1/0 AWG cable. Required if male plugs must be replaced or if additional plugs are needed. Kit includes one male Dinse-style plug which attaches to the work and/or weld cables and plugs into the Dinse-style receptacles on the power source.

Extension Kit for Dinse-Style Cable Connectors 042419

Accepts #4 to #1/0 AWG cable. Used to adapt or extend weld and/or work cables. Kit includes one male Dinse-style plug and one in-line female Dinse-style receptacle.

Trailers and Hitches (Note: Trailers are shipped unassembled.)



HWY-Mid Frame Trailer 301438

1,424-pound (646 kg) capacity highway trailer with welded steel tubing frame, heavy-duty axle with roller bearing hubs and leaf-spring suspension. Includes jack stand, fenders, lights, and dual hitch with 2-inch (50 mm) ball hitch and 3-inch (76 mm) lunette eye.

Cable Tree 043826

Provides an area to conveniently wrap weld cables and extension cords.



Dual Hitch 301441

Combination 2-inch (50 mm) ball hitch and 3-inch (76 mm) lunette eye in one reversible assembly.



2-In-1 Document/ Fire Extinguisher Holder 301236

Stores documents and holds a 5-pound fire extinguisher.

Note: Holder shown mounted on trailer. Fire extinguisher not included.

Mounting Specifications

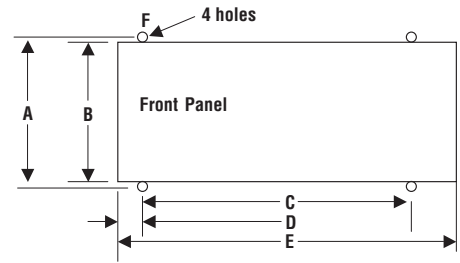

- A. 27.75 in. (705 mm)
- B. 26.25 in. (667 mm)
- C. 52.25 in. (1,327 mm)
- D. 2 in. (51 mm)
- E. 56 in. (1,422 mm)
- F. .562 in. (14 mm) diameter

Height: 32 in. (813 mm)
Width: 26.25 in. (667 mm)
Depth: 56 in. (1,422 mm)

Trailer Specifications (Subject to change without notice.)

Model	Gross Axle Weight Rating	Gross Vehicle Weight Rating	Net Payload	Height of Bed	Road Clearance	Track (Center to center of tires)	Standard Tires (Standard rating or P-size rating)	Dimensions	Net Weight
HWY-Mid Frame	1,605 lb. (728 kg)	1,424 lb. (646 kg)	1,424 lb. (646 kg)	19.5 in. (495 mm)	8 in. (203 mm)	46 in. (1,168 mm)	ST175/80D-13 Load Range C	Length: 101 in. (2,565 mm) Width: 55 in. (1,397 mm)*	181 lb. (82 kg)

*Width at outside of fenders.

Ordering Information

Equipment and Options	Stock No.	Description	Qty.	Price
Big Blue® 450 Duo CST™	907477	With Tweco®-style connectors		
Field Accessories				
Full KVA Plug Kit	119172	1-phase, 120/240 V, 50 A		
Engine Filter Kit	252782	Includes air, oil and fuel filters		
Spark Arrestor (Muffler) Kit	300585			
FA-1D Lockable Flame Arrestor Fuel Cap	043947			
Protective Cover	195301			
Stick Welding Leads		See page 3		
Weldcraft® TIG Torches		See page 3		
Plasma Cutting				
Spectrum® 375 X-TREME™	907529	12 ft. (3.7 m) torch. Includes X-CASE™ See literature PC/9.2		
Spectrum® 625 X-TREME™	907579	12 ft. (3.7 m) torch. Includes X-CASE™ See literature PC/9.6		
	907579001	20 ft. (6.1 m) torch. Includes X-CASE™ See literature PC/9.6		
Remote Controls		See page 3		
Cable Connectors and Adapters		See page 3		
Trailers and Hitches		See above		

Date:

Total Quoted Price:

Distributed by:

